

0.56" Dual Digit Display.

Part Number:

RL-D5610GDBW
RL-D5620SBRW

RL-D5610YCBW
RL-D5620RCBW

RL-D5620OCAW

Features

- 1.LOW POWER CONSUMPTION.
- 2.RELIABLE AND RUGGED.
- 3.EXCELLENT UNIFORMITY OF LIGHT OUTPUT.
- 4.SUITABLE FOR LEVEL INDICATOR.
- 5.I.C COMPATIBLE.
- 6.LONG LIFE-SOLIDSTATE RELIABILITY.

Notes:

- 1.All dimensions are in millimeters (inches)
- 2.Tolerance is $\pm 0.25(0.01)$ unless otherwise niter
- 3.Lead spacing is measured where the lead emerge package
- 4.Specifications are subject to change without notice

Package Dimensions & Internal Circuit Diagram.

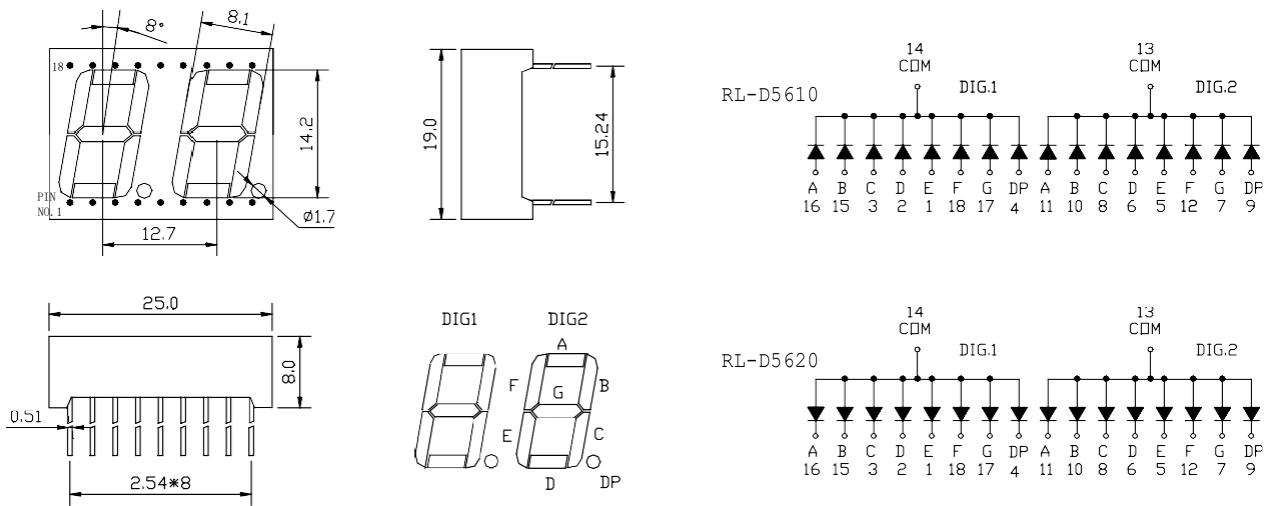

Selection Guide,

| Part NO. | Chip | | | Vf (V) | | | Face Color | C.C Or CA |
|--------------|-----------|---------------|------------------|--------|------|----------|------------|-----------------|
| | Material | Emitted Color | λ_p (nm) | Typ. | max | At IF=mA | | |
| RL-D5610GDBW | GaP | Yellow Green | 570 | 2000 | 3000 | 20 | Black | C.C. |
| RL-D5610YCBW | GaAsP/GaP | Yellow | 585 | 960 | 1440 | 20 | Black | C.C |
| RL-D5620OCAW | GaAsP/GaP | Orange Red | 630 | 1220 | 1830 | 20 | Gray | C.A. |
| RL-D5620SBRW | GaAlAs | Super Red | 660 | 2750 | 4120 | 20 | Red | C.A. |
| RL-D5620RCBW | GaP/GaP | Bright Red | 700 | 200 | 300 | 20 | Black | C.A. |

1.All dimensions are in millimeters (inches), Tolerance is $0.25(0.01)$ unless otherwise noted.

2.Specifications are subject to change without notice.

Part Number:

RL-D5611GDBW
RL-D5621SBRW

RL-D5611YCBW
RL-D5621RCBW

RL-D5621OCAW

Features

- 1.LOW POWER CONSUMPTION.
- 2.RELIABLE AND RUGGED.
- 3.EXCELLENT UNIFORMITY OF LIGHT OUTPUT.
- 4.SUITABLE FOR LEVEL INDICATOR.
- 5.I.C COMPATIBLE.
- 6.LONG LIFE-SOLIDSTATE RELIABILITY.

Notes:

- 1.All dimensions are in millimeters (inches)
- 2.Tolerance is 0.25(0.01)unless otherwise niter
- 3.Lead spacing is measured where the lead emerge package
- 4.Speciflcations are subject to change without notice

Package Dimensions & Internal Circuit Diagram.

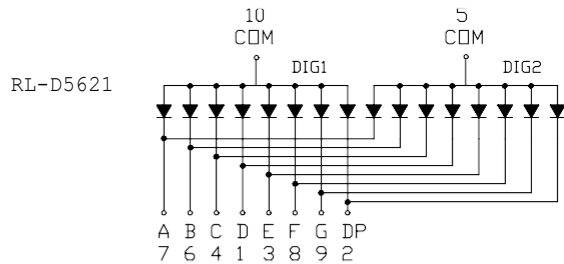
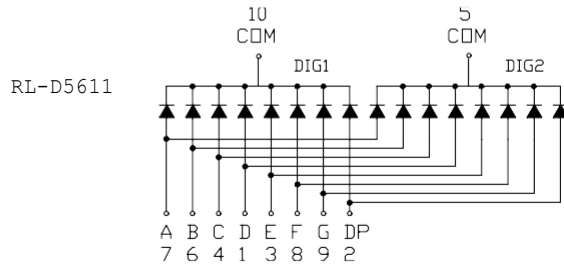
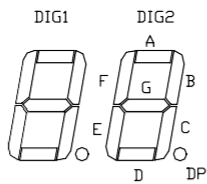
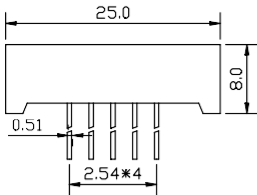
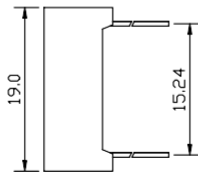
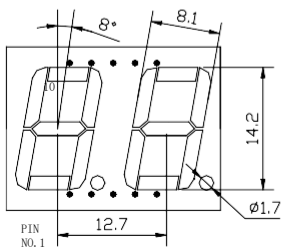

Selection Guide,

| Part NO. | Chip | | | Vf (V) | | | Face Color | C.C Or CA |
|--------------|-----------|---------------|------------------------|--------|------|-------------|------------|-----------------|
| | Material | Emitted Color | λ P (nm) | Typ. | Max | At IF=mA | | |
| RL-D5611GDBW | GaP | Yellow Green | 570 | 2000 | 3000 | 20 | Black | C.C. |
| RL-D5611YCBW | GaAsP/GaP | Yellow | 585 | 960 | 1440 | 20 | Black | C.C |
| RL-D5621OCAW | GaAsP/GaP | Orange Red | 630 | 1220 | 1830 | 20 | Gray | C.A. |
| RL-D5621SBRW | GaAlAs | Super Red | 660 | 2750 | 4120 | 20 | Red | C.A. |
| RL-D5621RCBW | GaP/GaP | Bight Red | 700 | 200 | 300 | 20 | Black | C.A. |

- 1.All dimensions are in millimeters (inches), Tolerance is 0.25(0.01) unless otherwise noted.
- 2.Specifications are subject to change without notice.

Part Number:

RL-D5613GDBW
RL-D5623SBRW

RL-D5613YCBW
RL-D5623RCBW

RL-D5623OCAW

Features

- 1.LOW POWER CONSUMPTION.
- 2.RELIABLE AND RUGGED.
- 3.EXCELLENT UNIFORMITY OF LIGHT OUTPUT.
- 4.SUITABLE FOR LEVEL INDICATOR.
- 5.I.C COMPATIBLE.
- 6.LONG LIFE-SOLIDSTATE RELIABILITY.

Notes:

- 1.All dimensions are in millimeters (inches)
- 2.Tolerance is 0.25(0.01)unless otherwise niter
- 3.Lead spacing is measured where the lead emerge package
- 4.Specifications are subject to change without notice

Package Dimensions & Internal Circuit Diagram.

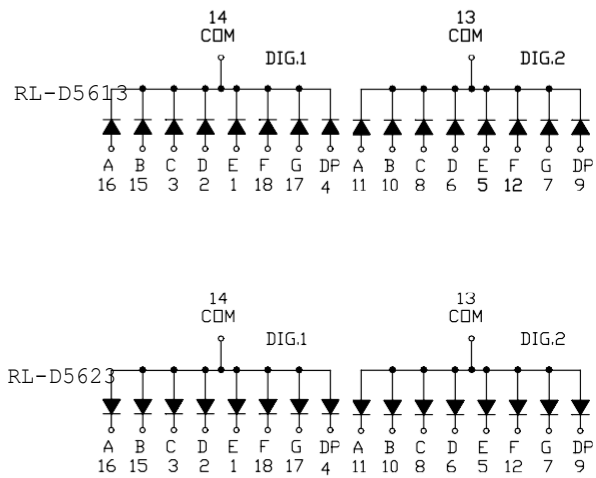
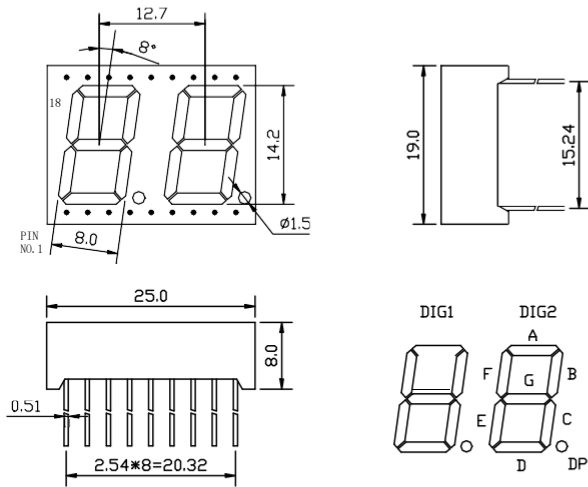

Selection Guide,

| Part NO. | Chip | | | Vf (V) | | | Face Color | C.C Or CA |
|--------------|-----------|---------------|----------|--------|------|----------|------------|-----------------|
| | Material | Emitted Color | λ P (nm) | Typ. | Max | At IF=mA | | |
| RL-D5613GDBW | GaP | Yellow Green | 570 | 2000 | 3000 | 20 | Black | C.C. |
| RL-D5613YCBW | GaAsP/GaP | Yellow | 585 | 960 | 1440 | 20 | Black | C.C |
| RL-D5623OCAW | GaAsP/GaP | Orange Red | 630 | 1220 | 1830 | 20 | Gray | C.A. |
| RL-D5623SBRW | GaAlAs | Super Red | 660 | 2750 | 4120 | 20 | Red | C.A. |
| RL-D5623RCBW | GaP/GaP | Bight Red ± | 700 | 200 | 300 | 20 | Black | C.A. |

- 1.All dimensions are in millimeters (inches), Tolerance is 0.25(0.01) unless otherwise noted.
- 2.Specifications are subject to change without notice.

0. 56 Dual Digit Display.

Electrical optical characteristics at TA=25°C.

| Symbol | Parameter | Device | Type. | Max. | Units | Test Conditions |
|------------------------|-----------------------|---|---------------------------------|---------------------------------|-------|------------------|
| λ_{peak} | Peak Wavelength | Yellow Green Yellow Orange Red Super Red Bright Red | 570 585 630 660 700 | | nm | IF-20mA |
| λ_D | Dominate Wavelength | Yellow Green Yellow Orange Red Super Red Bright Red | 560 580 610 640 690 | | nm | IF-20mA |
| $\Delta \lambda_{1/2}$ | Spectral Line Halfwit | Yellow Green Yellow Orange Red Super Red Bright Red | 30 35 45 20 45 | | nm | IF-20mA |
| C | Capacitance | Yellow Green Yellow Orange Red Super Red Bright Red | 15 20 15 45 40 | | pF | VF=0V; f=1MHZ |
| VF | Forward Voltage | Yellow Green Yellow Orange Red Super Red Bright Red | 2.1 2.0 2.0 1.7 2.1 | 2.8 2.8 2.8 2.8 2.8 | V | IF-20mA |
| IR | Reverse Current | All | | 10 | uA | VR=5V |

Absolute Maximum Ratings at TA=25°C.

| Parameter | Yellow Green | Yellow | Orange Red | Super Red | Bright Red | Units |
|----------------------|--------------|--------|------------|-----------|------------|-------|
| Power dissipation | 100 | 85 | 100 | 110 | 45 | mW |
| DC Forward Current | 25 | 25 | 25 | 25 | 25 | mA |
| Peak Forward Current | 160 | 160 | 160 | 200 | 50 | mA |
| Reverse Voltage | 5 | 5 | 5 | 5 | 5 | V |

NOTES:

1. Operating temperature: 40°C. TO 80°C.
2. Lead soldering: 260°C for 5 seconds.